

INDOOR COLLECTION













FULL/QUEEN BED

MATERIALS

- Powder-coated metal structural frame.
- Plywood wood slats.
- Hardwood headboard.

metal paint standards



wood finish standards



STANDARD DIMENSIONS

- Full Bed 82.1"L * 53.1"W
- Queen Bed 83"L * 60"W

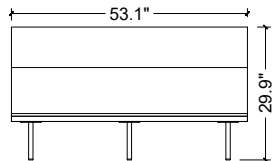
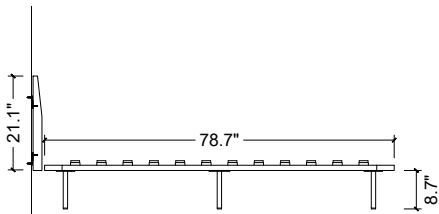
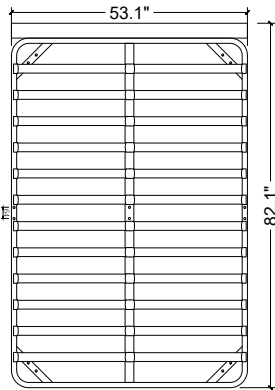

*ALL DIMENSIONS AND FINISHES ARE CUSTOMIZABLE.
*ADDITIONAL CHARGES MAY APPLY.

OFFICE CHAIR

MATERIALS

- Polished aluminum frame and base.
- Faux leather upholstery.
- Manual seat-height adjustment.

metal finish standards



fabric finish standards



STANDARD DIMENSIONS

- 21.5"L * 20.5"W * 27.6"H

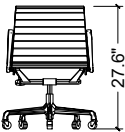
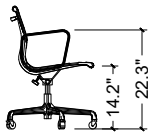
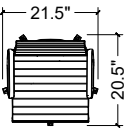

*ALL DIMENSIONS AND FINISHES ARE CUSTOMIZABLE.
*ADDITIONAL CHARGES MAY APPLY.

DINING SET

MATERIALS

- Powder-coated metal structural frame.
- Solid wood table top.
- Stain resistant boucle fabric.

metal paint standards



wood finish standards



STANDARD DIMENSIONS

- Table 47.2"DIA * 29.4"H
- Seat 22.3"W * 22.3"L * 26.9"H

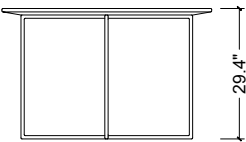
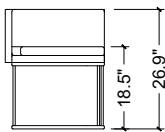
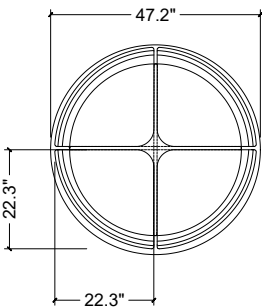

*ALL DIMENSIONS AND FINISHES ARE CUSTOMIZABLE.
*ADDITIONAL CHARGES MAY APPLY.



CLOSET

MATERIALS

- Powder-coated metal structural frame.
- Melamine doors and interior shelves.
- Heavy duty hardware.

metal paint standards



wood finish standards



STANDARD DIMENSIONS

- 34"L * 20.2"W * 86"H

*ALL DIMENSIONS AND FINISHES ARE CUSTOMIZABLE.
*ADDITIONAL CHARGES MAY APPLY.

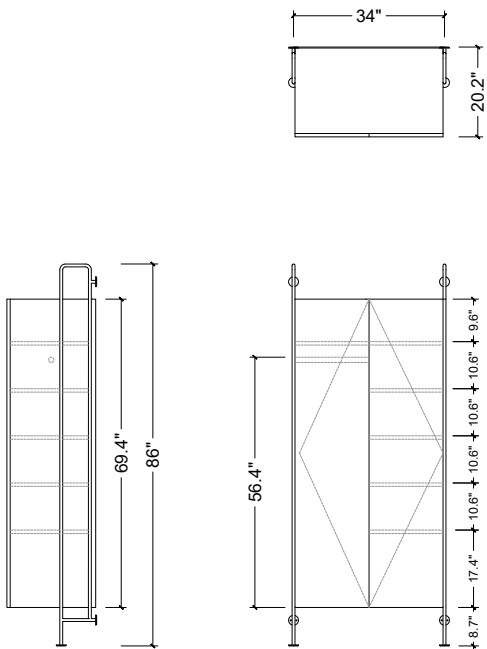



ARMOIRE

MATERIALS

- Powder-coated metal structural frame.
- Melamine doors and interior shelves.
- Solid wood base shelf.
- Heavy duty hardware.

metal paint standards



wood finish standards



STANDARD DIMENSIONS

- 34"L * 17.8"W * 86"H

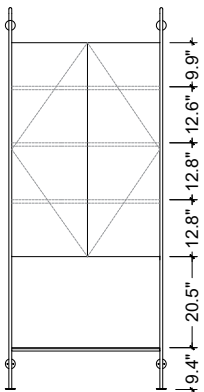
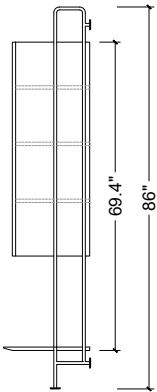
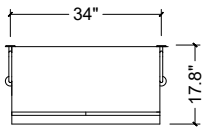

*ALL DIMENSIONS AND FINISHES ARE CUSTOMIZABLE.
*ADDITIONAL CHARGES MAY APPLY.



DESK

MATERIALS

- Powder-coated metal structural frame.
- Solid wood shelves and work surface.

metal paint standards



wood finish standards



STANDARD DIMENSIONS

- 24''L * 20.3''W * 86''H

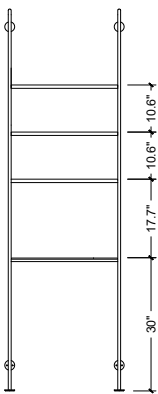
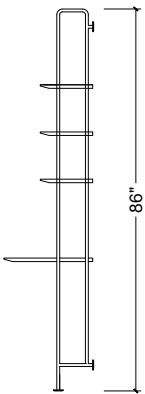
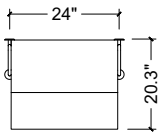

*ALL DIMENSIONS AND FINISHES ARE CUSTOMIZABLE.
*ADDITIONAL CHARGES MAY APPLY.

SOFA

MATERIALS

- Powder-coated metal structural frame.
- Solid wood side table.
- Faux leather bolster.
- Stain resistant boucle fabric.

metal paint standards



bolster finish standards



fabric finish standards



STANDARD DIMENSIONS

- Overall 70"L * 30.3"W * 28.5"H
- Seat 17.3"H

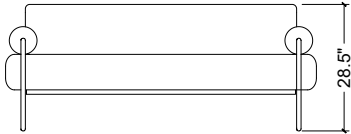
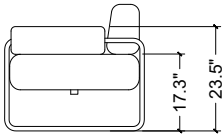
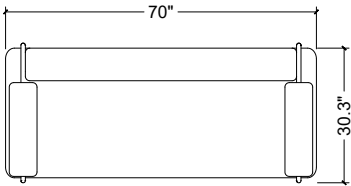

*ALL DIMENSIONS AND FINISHES ARE CUSTOMIZABLE.
*ADDITIONAL CHARGES MAY APPLY.

COFFEE TABLE

MATERIALS

- Powder-coated metal structural frame.
- Tempered glass shelves.

metal paint standards



glass color



STANDARD DIMENSIONS

- 41''L * 23''W * 16.3''H

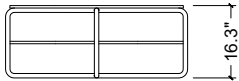
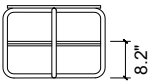
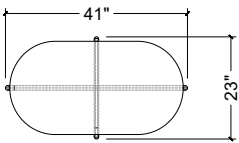

*ALL DIMENSIONS AND FINISHES ARE CUSTOMIZABLE.
*ADDITIONAL CHARGES MAY APPLY.

POUF

MATERIALS

- Stain resistant boucle fabric.

fabric standards



STANDARD DIMENSIONS

- 20" DIA * 20"H

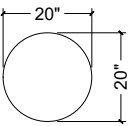

*ALL DIMENSIONS AND FINISHES ARE CUSTOMIZABLE.
*ADDITIONAL CHARGES MAY APPLY.

MARBLE TOP DINING TABLE WITH BASE

MATERIALS

- Marble top.
- Powder-coated steel base.

metal paint standards



marble



STANDARD DIMENSIONS

- 40"DIA * 29.2"H

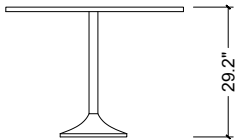
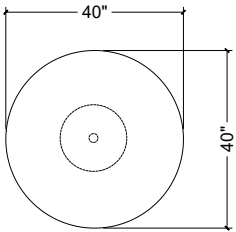

*ALL DIMENSIONS AND FINISHES ARE CUSTOMIZABLE.
*ADDITIONAL CHARGES MAY APPLY.

DINING CHAIR

MATERIALS

- Moulded polypropylene.
- Powder-coated metal base.

color



STANDARD DIMENSIONS

- 19.9”L * 19.1”W * 35.7”H

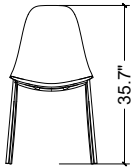
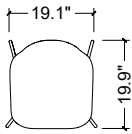

*ALL DIMENSIONS AND FINISHES ARE CUSTOMIZABLE.
*ADDITIONAL CHARGES MAY APPLY.

KITCHEN UNIT





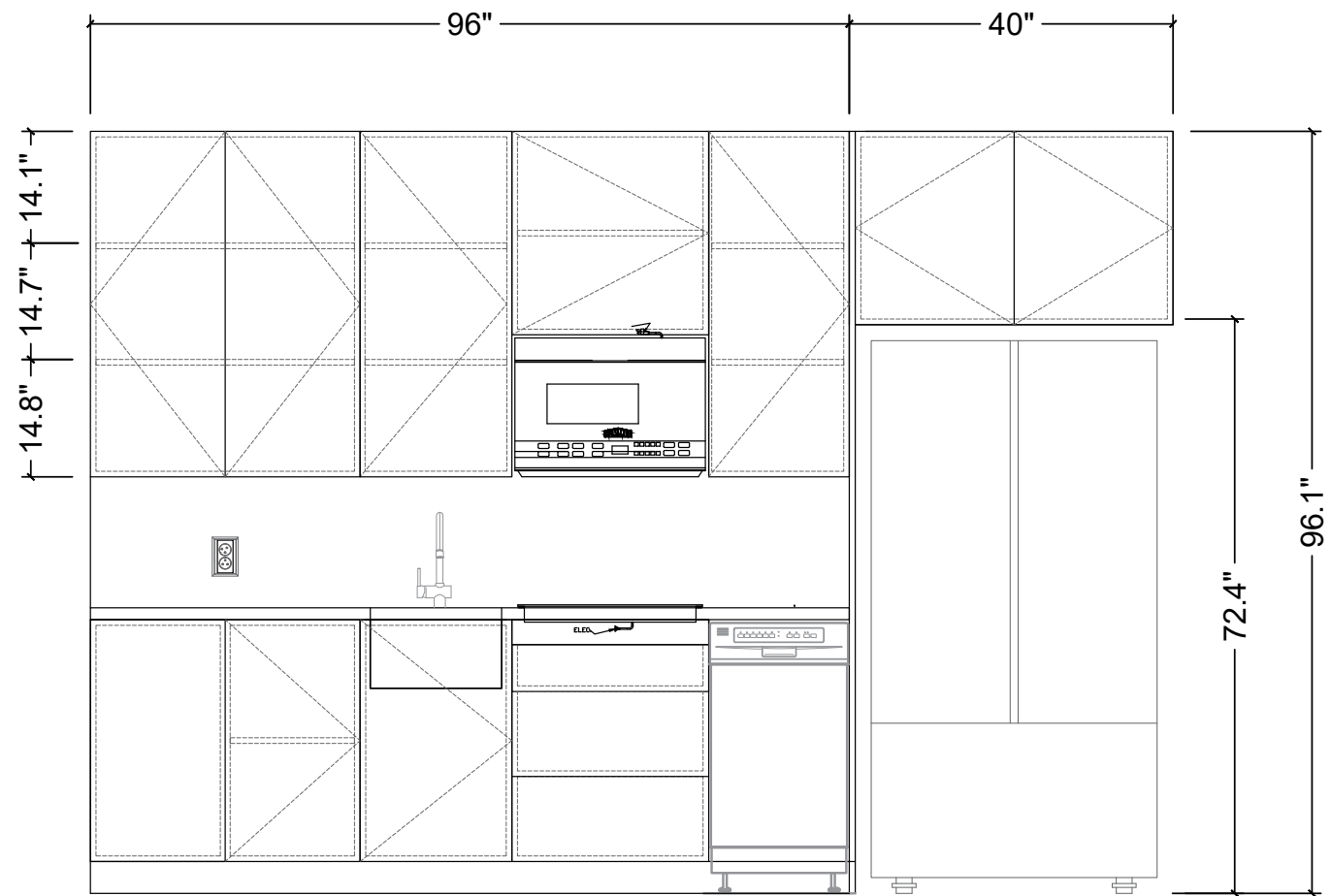
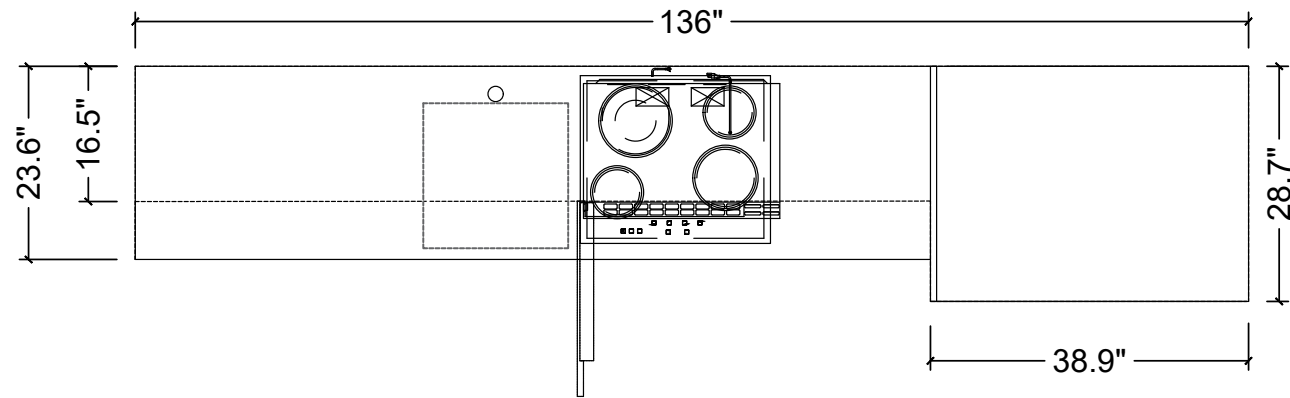
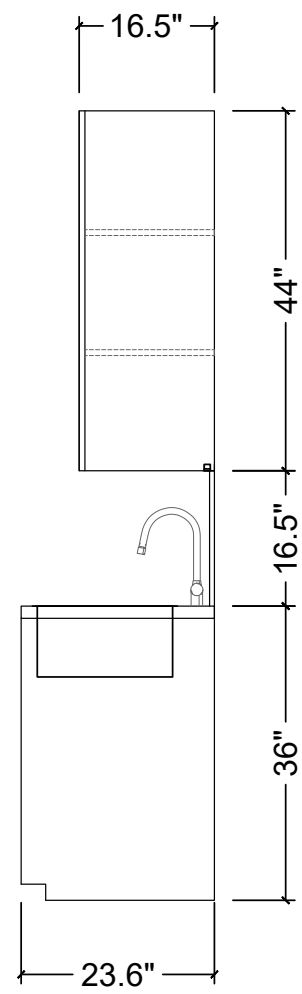

*ALL DIMENSIONS AND FINISHES ARE CUSTOMIZABLE.

*ADDITIONAL CHARGES MAY APPLY.

*MICROWAVE, REFRIGERATOR, COOK TOP, DISHWASHER AND LINEAR LIGHT ARE NOT INCLUDED.

BATHROOM FIXTURES

BATHROOM VANITY

MATERIALS

- Sintered stone top.
- Melamine cabinet.
- Integrated sink and faucet.

sintered stone top standards



metal finish standards



faucet standard



STANDARD DIMENSIONS

- 24''L * 18''W * 28''H

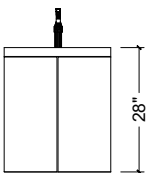
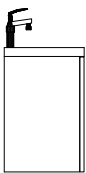
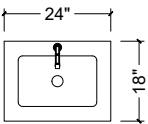

*ALL DIMENSIONS AND FINISHES ARE CUSTOMIZABLE.
*ADDITIONAL CHARGES MAY APPLY.

